

Tools Needed:

- 10mm Drill Bit
- 5mm Hex Bit

STEP 1

Bolt the blocks to the skirt but leave them snug. Do not tighten them all the way. Take note of the notches on the side of the block. The number of notches represents the location/number of the block. Block 1 is at the front of the car and Block 4 is at the rear.

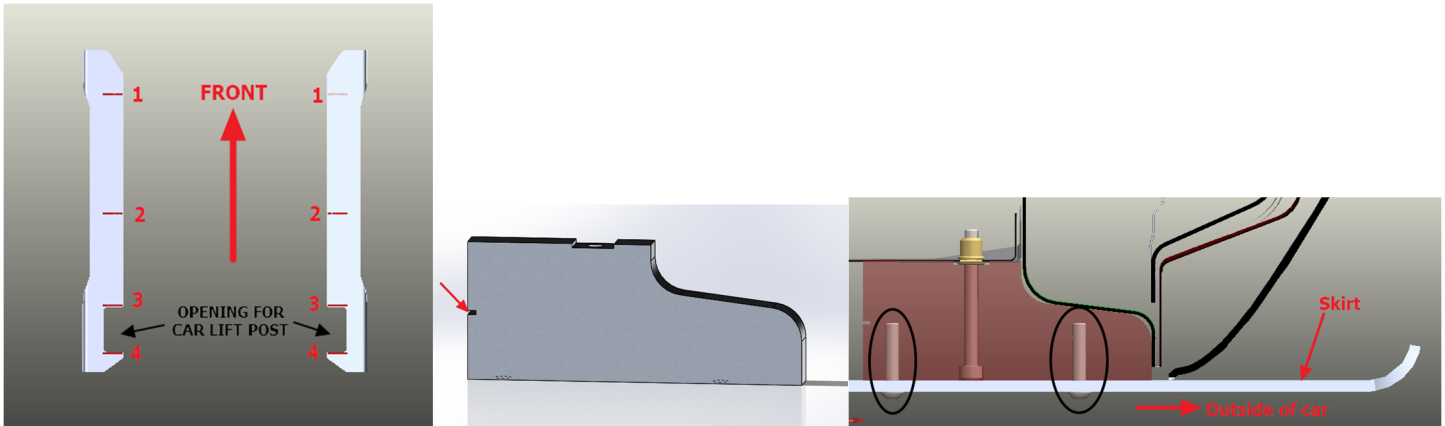

STEP 2

Hold the skirt up to the underside of the car and make sure the rear of the skirt is flush with the backside of the wheel well. Then mark the location of each block.

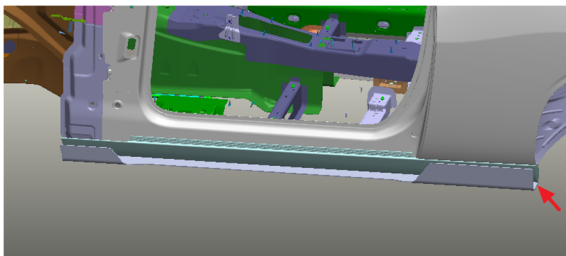

STEP 3

Remove the blocks from the skirts and put each one up to the locations marked. Mark the center hole, drill it out with a 10mm drill bit (do not try to oversize the hole!) and install the rivet nut using the quick tool provided. There is an instruction video on our website showing how to install the rivet nuts. Keep track of the center screws as they go with each block.

Tip: Using the same screw, put a dab of grease or tooth paste on the end and use it to mark the hole. We also highly recommend using a center punch prior to drilling to prevent the drill bit from walking and putting the hole in the wrong spot.

STEP 5

Bolt the blocks on to the car with 7ft.lbs of torque. Then bolt the skirts up to the blocks with 12ft.lbs of torque. We highly suggest adding some Blue Loctite to all of the screws.

STEP 6

That's it! Make sure to check the screws after a few days. IF you have any questions or want to send us your finished install pictures, please contact us at kdesignswings@gmail.com